



**mitsubishi
ELECTRIC**

Changes for the Better

High-speed hand dryer

Comfortable Speed Drying with Dual JET Airflow

High-speed Hand Dryer blows water off both the palm and back of your hand with one blast.

That is what we call dual JET drying. Therefore, your hands are dried quickly and cleanly.

This is available in our popular Slim Type with a stylish new form.

We deliver a new, great feeling to a variety of sanitary spaces from public restrooms to offices, retail stores, and factories.

Choose the best model to suit your needs from our full lineup.

You are sure to make good use of the Mitsubishi High-speed Hand Dryer.



Experience the difference of the High-speed Hand Dryer ease of use and comfort.

Advanced features

1 Independent air ducts

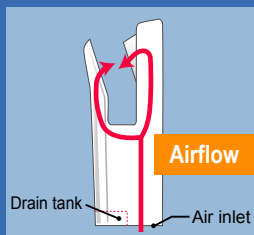

- Distinction Airflow from the drain completely.
- Water does not enter main unit.

2 Both sides open

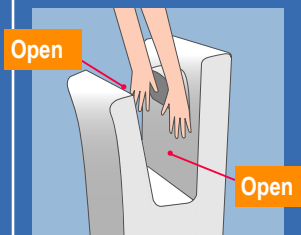

- Design allows easy insertion of your hands into the hand drying area and prevents water from blowing back.

3 Upper and lower sensors

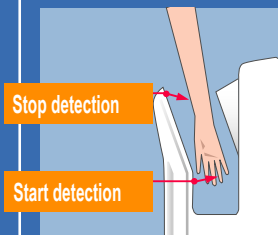

- Prevents water from blowing back towards the user.

4 Easy-to-use angle



- Comfortable angle and position for ease of use.

Mitsubishi Electric Sales Canada Inc.

4299 14th Avenue, Markham, Ontario, L3R 0J2

Tel: 1-800 268-9828 Fax: (905) 475-5231 www.jettowel.ca

SLIM TYPE



White (-W)

High-speed Hand Dryer Stand (Optional parts)



JP-S26FS-H (Gray)



SIAA is a guideline of the Society of Industrial-Technology for Antimicrobial Articles and showing on the products is announced the quality to the public officially.

The Antimicrobial performance of High-speed Hand Dryer was tested by Unitika Garments Technology & Research Laboratories LTD.

JT-SB216DS

Antimicrobial

Single phase 220-240V

- The unit can use a 220-240V current at factories, etc.
- The unit can be connected to the circuit box to interlock it with the automatic door.

Newly introduced form is well suited to a variety of room styles and decor. Dual jet drying will become the standard of the next generation.

- Speed drying** •Dual jet drying with airflow rate of 90 m/s*1 achieves high-speed drying in 5-6 seconds.
- Easy to use** •New arc-shaped nozzle arrangement* reduces water being blown back and is comfortable and easy to use.

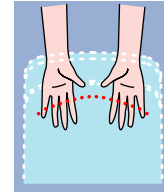

*New arc-shaped nozzle arrangement

- Sanitary** •The hand drying area, drain tank, and even drain hose have all been antimicrobially treated for better sanitation.
- Alcohol-resistant resin used for the hand drying area allowing cleaning with alcohol*2.

*1: Measurement taken at the nozzle outlet. High speed drying in 5-6 seconds. (Drying time according to Mitsubishi measurement methods)

*2: Disinfectant-use ethanol (83% or lower concentration) recommended.

High-efficient, economical operation with easy maintenance. Can be installed in a variety of locations.

For facilities where service is important

- Large office buildings
- Hotels
- Restaurants
- Food factory
- Department stores
- Amusement centers
- Factory
- Casino
- Supermarkets, etc.

Compact sanitary areas



•Can be mounted in recessed wall areas.

For areas without wall mounting



Installation using optional High-speed Hand Dryer stand. (optional parts)
•Can be installed with High-speed Hand Dryer stand. (optional parts)

Main Specifications for JT-SB216DS

External Diagram JT-SB216DS

Recommended dimensions for installation

For men	890
For women	870

For one JIS switch box

Mounting Diagram JT-SB216DS

Guide for mounting positions
For men: 890mm
For women: 870mm

(Unit: mm)

*Mount the unit so that the name plate label on the side of the unit can be read.

*Red items are measurements related to power supply.

Drying method	Model	Drying time (high)	Airflow rate (high)	External dimensions (mm)	Power supply	Rated current (A)	Power consumption (W)	Motor type	Safety components	Power cord	Drain tank (L)	Weight (kg)
Dual JET Airflow drying	JT-SB216DS	5-6 seconds	90m/s	W300 x D220 x H687	Single phase 220-240V 50-60Hz	4.0	650	DC brushless motor	Temperature fuse Over current breaker	None(Power supply connected to quick-connect terminal)	0.8	11

*The drying times were obtained using Mitsubishi Electric's own measurement method.
*The airflow rate is measured at the nozzle outlet.